

Page 1

[Emblem] OMEGA ENGINEERING, INC
ANNEX A
MEASUREMENT DRAWING AND TOPOGRAPHY
Plaza Banco Central. Office 16 AC, Calle Aquilino De La Guardia y Calle 50. Bella Vista. Panama City.
Republic of Panama. Telephone 507.380.0251. Fax 507.380.0252

Page 2

[Handwritten] Property of the Ministry of Agricultural and Livestock Development

| FIELD DATA | | |
|------------|--------|-------------|
| ST. | DIST. | DIRECTION |
| 1-2 | 11.86 | N 65' 12' E |
| 2-3 | 27.50 | N 77' 12' E |
| 3-4 | 17.76 | N 86' 19' E |
| 4-5 | 32.16 | S 89' 27' E |
| 5-6 | 42.53 | S 84' 46' E |
| 6-7 | 20.00 | N 87' 57' E |
| 7-8 | 20.00 | N 79' 42' E |
| 8-9 | 20.00 | N 68' 00' E |
| 9-10 | 48.88 | N 15' 36' W |
| 10-11 | 80.00 | N 27' 10' W |
| 11-12 | 223.30 | S 82' 01' W |
| 12-13 | 69.54 | S 29' 12' E |

[Handwritten] NOTE: THE POLYGON WAS BUILT BY THE PROPERTY LINE IN ALL ITS EXTENSION.
M: CONCRETE MONUMENT

V: STEEL ROD

PIECE OF LAND SEGREGATED OF PROPERTY NO. 11465. VOLUME NO. 1035, PAGE NO. 80
PROPERTY OF MIDA. "RIO SERENO" PROPERTY

[Illegible stamp]

[Illegible seal]

[Illegible signature]

[Handwritten] 07-Dec-2001

[Illegible signature]

TECHNICIAN ELMER RODRIGUEZ. COORDINATION. DIS. CHIRIQUI

REPUBLIC OF PANAMA.

VILLAGE: RIO SERENO

DISTRICT: RENACIMIENTO

PLACE: LOS PINOS

PIECE OF LAND REQUESTED AS A DONATION BY THE NATION TO MAKE IT AVAILABLE FOR
THE

MINISTRY OF HEALTH – RIO SERENO

AREA: 2 Has + 6005.73 m2

LEU: FRANKLIN ACOSTA

CAL: FRANKLIN ACOSTA

DIS: ARTURO RUSSO G.

SCALE: 1:1000

DATE: JULY 2000

ARTURO RUSSO GONZALEZ

TOPOGRAPHY TECHNICIAN

PROFESSIONAL LICENSE NO. 85-306-003

[Illegible signature]

SIGNATURE

REGIONAL LOCATION
MOORING BASE POINT

| FIELD DATA | | | | |
|------------|---------|-----------------|------------|------------|
| LINE | DIST. | DIRECTION | NORTH | EAST |
| 1-2 | 93.47 m | N 05° 43' 22 W | 975811.695 | 297228.526 |
| 2-3 | 95.13 m | S 85° 25' 07' W | 975904.696 | 297219.206 |
| 3-4 | 96.81 m | S 11° 03' 49' E | 975897.017 | 297123.381 |
| 4-1 | 66.94 m | N 53° 37' 23' E | 975802.039 | 297142.125 |

[Two illegible stamps]

PANAMA, REPUBLIC OF PANAMA
CHIRIQUI PROVINCE RENACIMIENTO DISTRICT
RIO SERENO VILLAGE PLACE: HEALTHCARE CENTER

PLAN SHOWING PLANIMETRY AND TOPOGRAPHY FOR THE PRIMARY AND COMPREHENSIVE HEALTHCARE CENTER

[Illegible stamp]
SCALE: INDICATED
DATE: APRIL 2011
REVISION: R- HILL C. QUIROS
CONTENT:
FILE: [illegible]
SHEET NO.: 1
TOTAL: 1

Page 4
TOPOGRAPHIC PLANT (NATURAL LAND) SCALE: 1:250

[Illegible seal]
CAUTION: IF THIS SHEET DOES NOT MEASURE 0.9144 m X 0.6096 m IT IS A REDUCTION SHEET NO.
CONTENT: CIVIL – 1

| DATE | OBSERVATIONS |
|------------------------|---|
| 01-28-12 | DRAFT PROJECT DELIVERY TO MMSA |
| 02-07-12 | DRAFT PROJECT REVIEWED WITH MINSAs COMMENTS |
| [Handwritten] 02-28-12 | [Handwritten] ORIGINAL UNPAVED ROADS APPROVED FOR CONSTRUCTION. |
| WORK NO. | [Illegible] |

ALL THE DIMENSIONS APPEAR IN METERS

GABRIEL GUEVARA SOLIS. CIVIL ENGINEER. PROFESSIONAL LICENSE NO. 003-085-061
[Illegible signature]
SIGNATURE
Act 15 from 28-January-1959
Engineering and Architecture Technical Board

MARIA C. FRANCO CAMPOS. ARCHITECT. PROFESSIONAL LICENSE NO. [Illegible]
[Illegible signature]
SIGNATURE

Act 15 from 28-January-1959
Engineering and Architecture Technical Board

[Emblem] LOGO Salud
BUILDER: OMEGA ENGINEERING, INC
ARCHITECT: WARE MALCOMB

DRAFT PROJECT
CONSTRUCTION
INNOVATIVE PRIMARY HEALTHCARE CENTER
(MIMSA CAPSIRIO SERENO)

OWNER: MIMSA
LOCATION: CHIRIQUI PROVINCE
RIO SERENO VILLAGE
RENACIMIENTO DISTRICT

OSCAR L. RIVERA RIVERA
LEGAL REPRESENTATIVE
OMEGA ENGINEERING, INC
421723037
DATE: FEBRUARY 2012
SHEET: 1/3

STRUCTURAL CALCULATION:
ELECTRICAL CALCULATION:
SANITARY CALCULATION:
MECHANICAL CALCULATION:
PLAN DEVELOPMENT:
F.T.M. / G.G.

MINISTRY OF HEALTH, LEGAL REPRESENTATIVE
SIGNATURE AND ID CARD

HEALTH INFRASTRUCTURE DIRECTOR / DIG-MINSA

MUNICIPAL WORKS AND CONSTRUCTIONS DIRECTOR

ARCHITECTURE DEPARTMENT CHIEF
DIG / MINS
REVIEWED

Page 5
TOPOGRAPHIC PLANT (NATURAL LAND) SCALE: 1:250

CAUTION: IF THIS SHEET DOES NOT MEASURE 0.9144 m X 0.6096 m IT IS A REDUCTION

HEALTH INFRASTRUCTURE OFFICE
DAI-DIS-MINSA INSPECTION
PRELIMINARY REVISION
APPROVED FOR CONSTRUCTION
Date [Handwritten] 27-Feb-2012
Signature [Illegible signature]

[Illegible seal]

SHEET NO.
CONTENT: CIVIL – 1

| DATE | OBSERVATIONS |
|------------------------|--|
| 01-28-12 | DRAFT PROJECT DELIVERY TOMMSA |
| 02-07-12 | DRAFT PROJECT REVIEWED WITH MINSA COMMENTS |
| [Handwritten] 09-05-12 | APPROVAL |
| WORK NO. | [Illegible] |

ALL THE DIMENSIONS APPEAR IN METERS

GABRIEL GUEVARA SOLIS. CIVIL ENGINEER. PROFESSIONAL LICENSE NO. 003-085-061

[Illegible signature]

SIGNATURE

Act 15 from 28-January-1959

Engineering and Architecture Technical Board

MARIA C. FRANCO CAMPOS. ARCHITECT. PROFESSIONAL LICENSE NO. [Illegible]

[Illegible signature]

SIGNATURE

Act 15 from 28-January-1959

Engineering and Architecture Technical Board

[Emblem] LOGO Salud

BUILDER: OMEGA ENGINEERING, INC

ARCHITECT: WARE MALCOMB

DRAFT PROJECT

CONSTRUCTION

INNOVATIVE PRIMARY HEALTHCARE CENTER

(MIMSA CAPSIRIO SERENO)

OWNER: MIMSA

LOCATION: CHIRIQUI PROVINCE

RIO SERENO VILLAGE

RENACIMIENTO DISTRICT

OSCAR L. RIVERA RIVERA

LEGAL REPRESENTATIVE

OMEGA ENGINEERING, INC

421723037

DATE: FEBRUARY 2012

SHEET:

STRUCTURAL CALCULATION:

ELECTRICAL CALCULATION:

SANITARY CALCULATION:

MECHANICAL CALCULATION:

PLAN DEVELOPMENT:

F.T.M. / G.G.

MINISTRY OF HEALTH, LEGAL REPRESENTATIVE

SIGNATURE AND ID CARD

HEALTH INFRASTRUCTURE DIRECTOR / DIG-MINSA

MUNICIPAL WORKS AND CONSTRUCTIONS DIRECTOR

ARCHITECTURE DEPARTMENT CHIEF
DIG / MINSA
REVIEWED

CONTRACT SET

Page 6

CALLE PRIMERA PROFILE SCALE: 1:200
CALLE SEGUNDA PROFILE SCALE: 1:200
PARKING LOTS PROFILE SCALE: 1:200
CALLE PRIMERA
PERPENDICULAR SECTIONS
SECTION XI – PROJECT SCALE: 1:200

CAUTION: IF THIS SHEET DOES NOT MEASURE 0.9144 m X 0.6096 m IT IS A REDUCTION

GABRIEL GUEVARA SOLIS. CIVIL ENGINEER. PROFESSIONAL LICENSE NO. 003-085-061
[Illegible signature]
SIGNATURE
Act 15 from 28-January-1959
Engineering and Architecture Technical Board

MARIA C. FRANCO CAMPOS. ARCHITECT. PROFESSIONAL LICENSE NO. [Illegible]
[Illegible signature]
SIGNATURE
Act 15 from 28-January-1959
Engineering and Architecture Technical Board

SHEET NO.
CONTENT: CIVIL – 3

| DATE | OBSERVATIONS |
|------------------------|--|
| 01-28-12 | DRAFT PROJECT DELIVERY TO MMSA |
| 02-07-12 | DRAFT PROJECT REVIEWED WITH MINSA COMMENTS |
| [Handwritten] 09-05-12 | APPROVAL |
| WORK NO. | [Illegible] |

ALL THE DIMENSIONS APPEAR IN METERS

HEALTH INFRASTRUCTURE OFFICE
DAI-DIS-MINSA INSPECTION
PRELIMINARY REVISION
APPROVED FOR CONSTRUCTION
Date [Handwritten] 27-Feb-2012
Signature [Illegible signature]

[Emblem] LOGO Salud
BUILDER: OMEGA ENGINEERING, INC
ARCHITECT: WARE MALCOMB

DRAFT PROJECT
CONSTRUCTION
INNOVATIVE PRIMARY HEALTHCARE CENTER
(MIMSA CAPSIRIO SERENO)

OWNER: MIMSA
LOCATION: CHIRIQUI PROVINCE
RIO SERENO VILLAGE
RENACIMIENTO DISTRICT

OSCAR L. RIVERA RIVERA
LEGAL REPRESENTATIVE
OMEGA ENGINEERING, INC
421723037
DATE: FEBRUARY 2012
SHEET:

STRUCTURAL CALCULATION:
ELECTRICAL CALCULATION:
SANITARY CALCULATION:
MECHANICAL CALCULATION:
PLAN DEVELOPMENT:
F.T.M. / G.G.

MINISTRY OF HEALTH, LEGAL REPRESENTATIVE
SIGNATURE AND ID CARD

HEALTH INFRASTRUCTURE DIRECTOR / DIG-MINSA

MUNICIPAL WORKS AND CONSTRUCTIONS DIRECTOR

ARCHITECTURE DEPARTMENT CHIEF
DIG / MINSAs
REVIEWED

CONTRACT SET

ANEJO A

PLANOS DE MENSURA Y TOPOGRAFIA

Plaza Banco General
Oficina 16 AC,
Calle Aquilino De La Guardia y Calle 50
Bella Vista
Ciudad de Panamá
República de Panamá
T. 507.380.0251
F. 507.380.0252

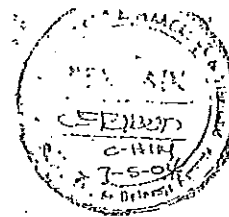

| DATOS DE CAMPO | | |
|----------------|--------|-------------|
| EST. | DIST. | RUMBOS |
| 1-2 | 11.86 | N 65° 12' E |
| 2-3 | 27.50 | N 77° 12' E |
| 3-4 | 17.76 | N 86° 19' E |
| 4-5 | 32.14 | S 89° 27' E |
| 5-6 | 42.53 | S 84° 46' E |
| 6-7 | 20.00 | N 87° 57' E |
| 7-8 | 20.00 | N 79° 42' E |
| 8-9 | 20.00 | N 68° 00' E |
| 9-10 | 48.88 | N 15° 36' W |
| 10-11 | 80.00 | N 27° 10' W |
| 11-12 | 223.30 | S 82° 01' W |
| 12-13 | 69.54 | S 29° 12' E |

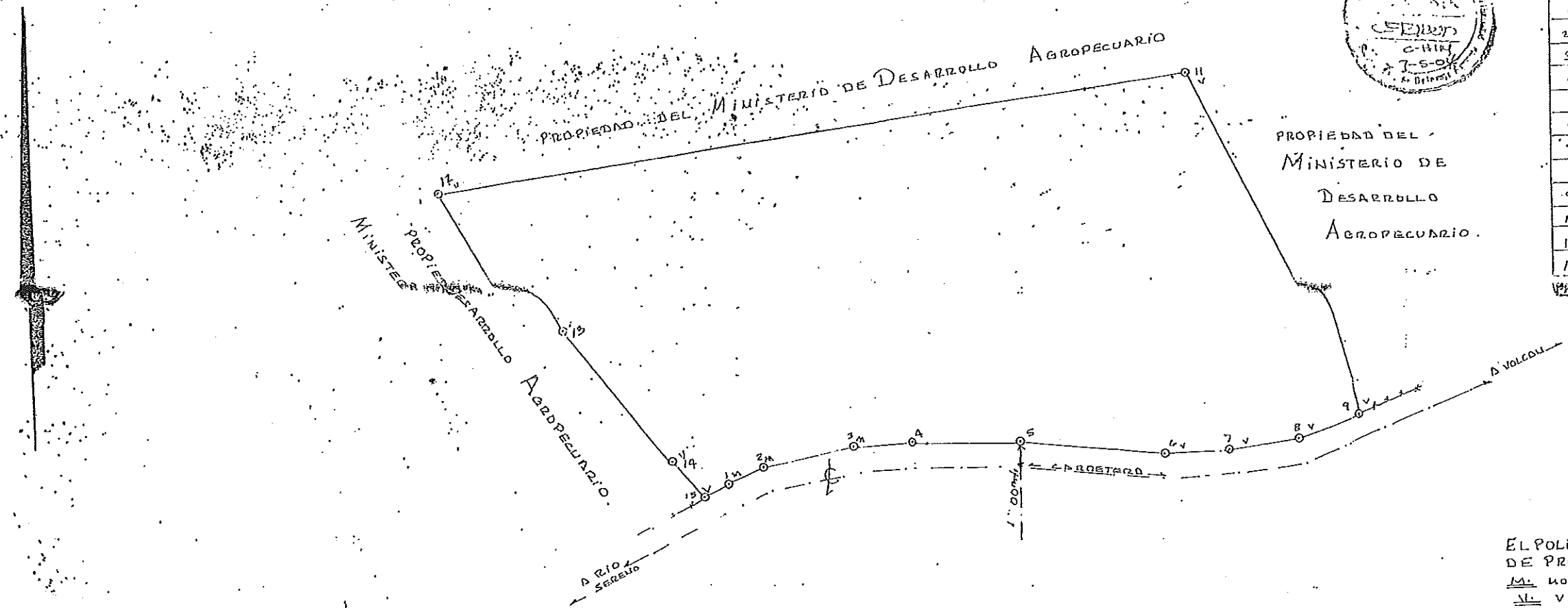

MULA
 EL POLIGONO FUE LEVANTADO POR LA LINEA DE PROPIEDAD EN TODA SU EXTENSION.
M: MONUMENTO DE CONCRETO.
V: VARILLA DE ALERO
 GLOBO DE TERRENO SECREGADO DE LA FINCA No 11465 TOMO No 1035 FOLIO No 80 PROPIEDAD DEL HIDA... FINCA "RIO SERENO"

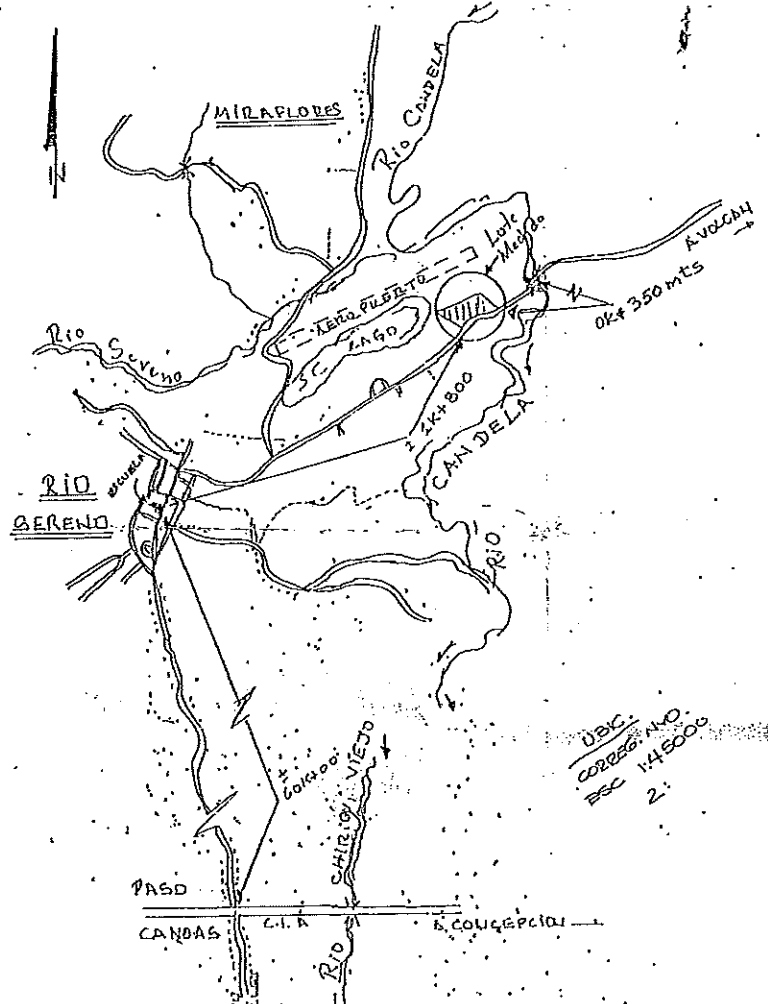

REPUBLICA DE PANAMA
 FEDERACION NACIONAL DE PROPIETARIOS AGRIAS
 No. 11465-14500
 10 Mayo 2002
 AMORADO

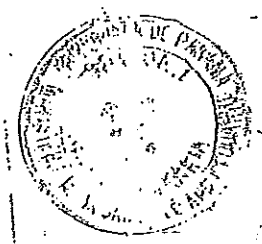

Samuel J. Lopez
 07-12-2001

REPUBLICA DE PANAMA
 PROVINCIA: CHIRIQUI | CORREGIMIENTO: RIO SERENO
 DISTRITO: RENACIMIENTO | LUGAR: LOS PINOS.

GLOBO DE TERRENO SOLICITADO EN DONACION POR LA NACION PARA PONERLO A DISPOSICION DEL:
MINISTERIO DE SALUD: RIO SERENO

AREA: 2 Has + 6005.73 m²
 LEV: FRANKLIN ACOSTA
 CAL: FRANKLIN ACOSTA
 DIR: ARTURO RUSSO G.
 ESCALA: 1:1000
 FECHA: 3 JULIO 2000
 ARTURO RUSSO GONZALEZ
 TECNICO EN TOPOGRAFIA
 LICENCIA No 85-304-003
Arturo Russo Gonzalez
 FIRMA
 Ley 14 de 19 de febrero de 1977

TECNICO ALMER RODRIGUEZ
 COORDINADOR D.I. S. - CHIRIQUI

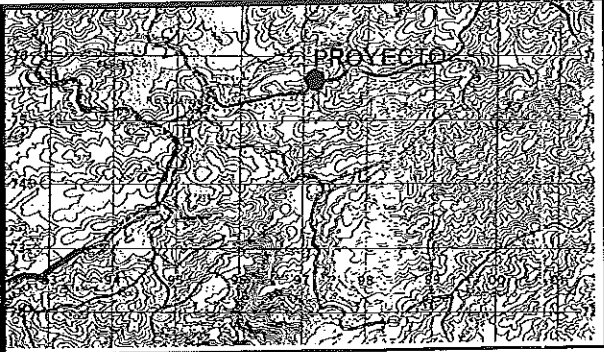

LOCALIZACION REGIONAL

Explicar

| FORMA TECNICA DE SEÑAL GEODESICA | | | |
|----------------------------------|------------|-----------|------------|
| Numero de Estación | Altimetria | Distancia | Altimetria |
| 1 | 1.5 | 1.5 | 1.5 |
| 2 | 1.5 | 1.5 | 1.5 |
| 3 | 1.5 | 1.5 | 1.5 |
| 4 | 1.5 | 1.5 | 1.5 |
| 5 | 1.5 | 1.5 | 1.5 |
| 6 | 1.5 | 1.5 | 1.5 |
| 7 | 1.5 | 1.5 | 1.5 |
| 8 | 1.5 | 1.5 | 1.5 |
| 9 | 1.5 | 1.5 | 1.5 |
| 10 | 1.5 | 1.5 | 1.5 |

PUNTO BASE DE AMARRE

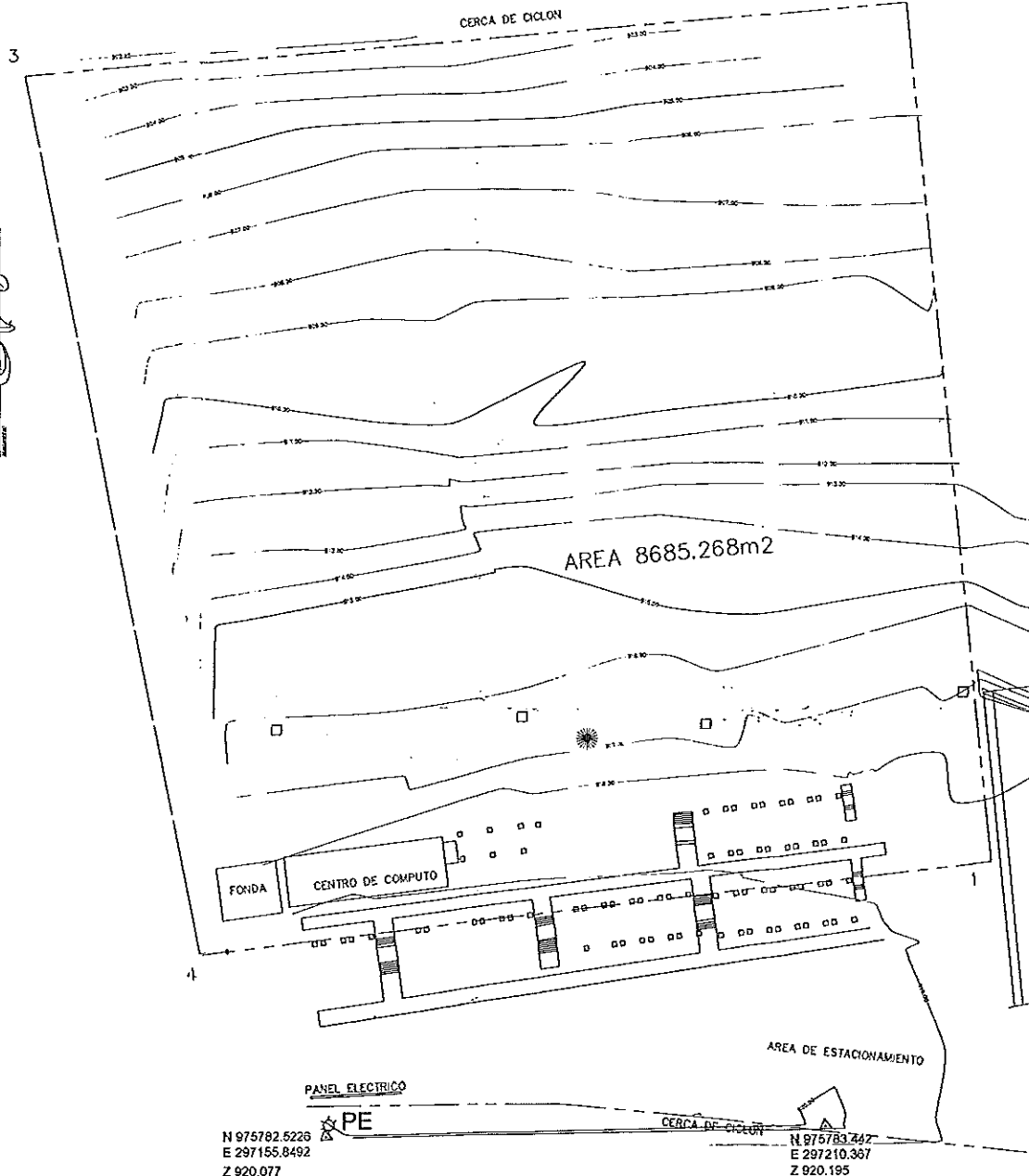

| DATOS DE CAMPO | | | | |
|----------------|--------|-------------|------------|------------|
| LINEA | DIST. | RUMBO | NORTE | ESTE |
| 1-2 | 83.47m | N05°43'22"W | 875811.695 | 297228.626 |
| 2-3 | 98.13m | S85°25'07"E | 875904.698 | 297219.206 |
| 3-4 | 96.81m | S11°03'49"E | 875897.017 | 297123.581 |
| 4-1 | 68.84m | N63°37'23"E | 875902.039 | 297142.128 |

MINISTERIO DE SALUD
DIRECCION NACIONAL DE INFRAESTRUCTURA DE SALUD
DEPARTAMENTO DE APPLICACIONES
[Signature]
RECIBIDO
08-junio-2011
TSP/A

MINISTERIO DE SALUD
DIRECCION NACIONAL DE INFRAESTRUCTURA DE SALUD
DEPARTAMENTO DE ARQUITECTURA
PLAN: *Region A*
FECHA: *27-junio-2011*
Elaborado por: [Signature]
Revisado por: [Signature]
Observaciones: Sobre los cuadros de Nivel, sobre niveles constructivos, cables de acero y soldado, señalar nivel de terminado propuesto y fondo de obra de fierro (cable y barras armadas), poner de acento por abrigos, retobanos, procedimiento constructivo para el caso de niveles de fierro propuestos.

PANAMA, REPUBLICA DE PANAMA
PROVINCIA DE CHIRIQUI - DISTRITO DE RENACIMIENTO
CORREGIMIENTO RIO SERENO - LUGAR CENTRO DE SALUD

PLANO DEMOSTRATIVO DE DE PLANIMETRIA Y TOPOGRAFIA
PARA EL CENTRO DE ATENCION PRIMARIA Y SALUD INTEGRAL

| | | |
|-------------------------------|------------|----------------|
| | ESCALA: | CONTENIDO: |
| | INDICADA | |
| | FECHA: | ARCHIVO: |
| | ABRIL 2011 | NO SEFRENDA/DA |
| REVISION R. HILL C. QUIROS | HOJA N°: | TOTAL: |
| | 1 | 1 |

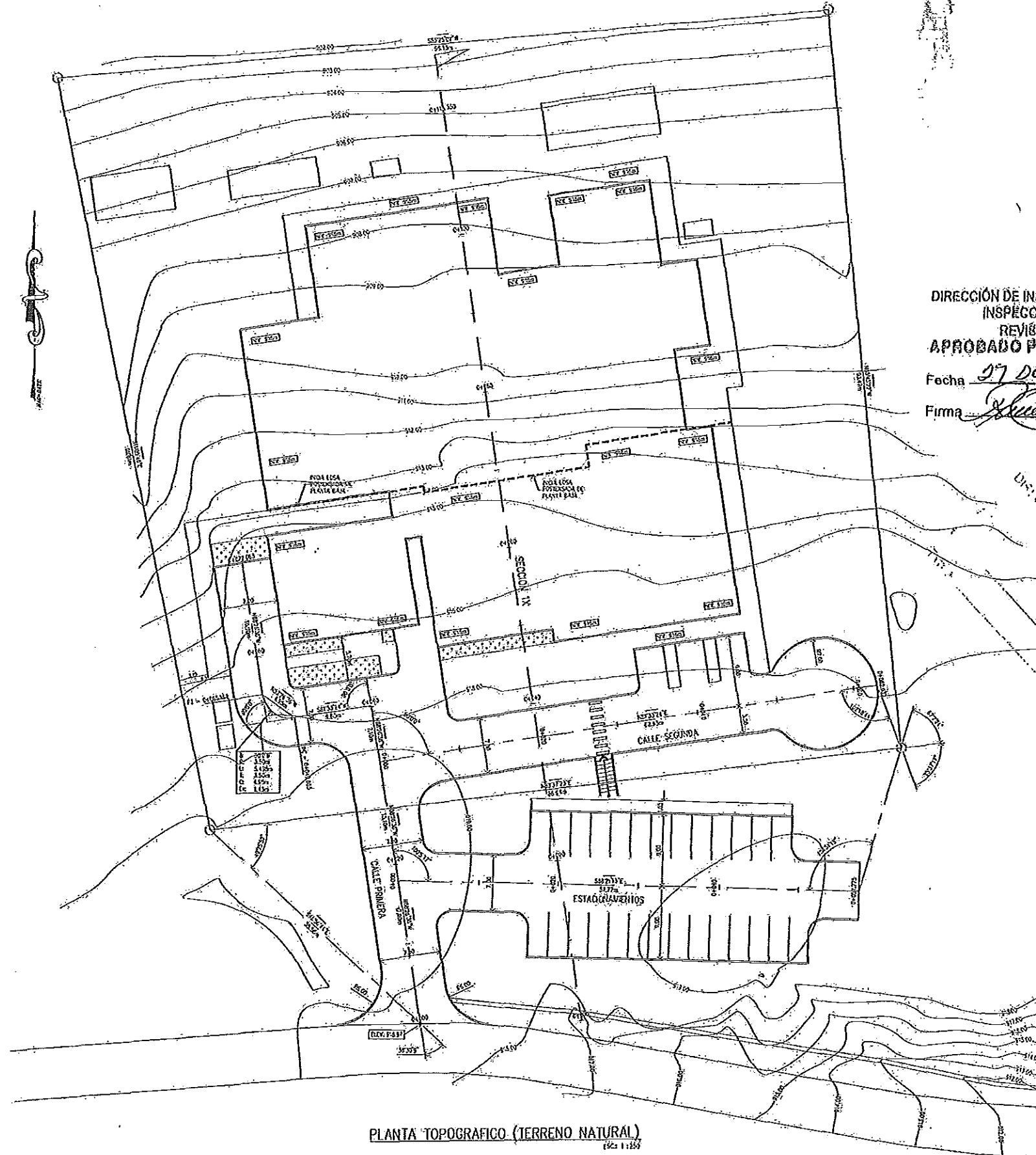

DIRECCION DE INFRAESTRUCTURA DE SALUD
 INSPECCION DAI-DIS-MINSA
 REVISION PRELIMINAR
 APROBADO PARA CONSTRUCCION

Fecha 27 DE Febrero 2012

Firma *[Signature]*

PLANTA TOPOGRAFICO (TERRENO NATURAL)
 ESC. 1:125

CONTRACT SET

Nº. DE LA HOJA

CIVIL-1

| | |
|----------|--------------|
| FECHA | CONSTRUCCION |
| 17/02/12 | 17/02/12 |

TODAS LAS DIMENSIONES SON EN METROS

GABRIEL GUEVARA SOLIS
 INGENIERO CIVIL
 M.D. 1963-08-03
 Nº. 17157
 Ley 15 del 18 de Enero de 1959
 Junta Técnica de Ingeniería y Arquitectura

MARIA C. FRANCO CAMPOS
 ARQUITETA
 Nº. 13007
 Ley 15 del 18 de Enero de 1959
 Junta Técnica de Ingeniería y Arquitectura

| | |
|---|--|
| ANTERECEDENTE: EDIFICACION CENTRO DE ATENCION PRIMARIA DE CALILO - INDO VAGERA (MUNICIPIO CARAJI - POB. 20000) PROPIETARIO: MINISA UBICACION: PROVINCIA DE CHIRIQUI CORREGIMIENTO DE RIO OSERNO DISTRITO DE REGIMIENTO SECTOR CONSTRUCCION | UNIDAD DE SALUD: INSTITUCION REGIONAL PRIMA Y SECUNDA |
| REALIZADO POR: INGENIERIA Y ARQUITECTURA CIVIL GABRIEL GUEVARA SOLIS | DIRECCION DE INFRRAESTRUCTURA DE SALUD |
| PROYECTO: CALCULO DE CORTAVES Y CONSTRUCCION DE MANCHAS | DIRECCION DE OBRAS Y CONSTRUCCION MUNICIPAL |
| CLIENTE: MUNICIPIO DE CARAJI | SECRETARIA DE SALUD MUNICIPAL |
| UBICACION: MUNICIPIO DE CARAJI CANTON OSERNO DISTRITO DE REGIMIENTO | SECRETARIA DE SALUD MUNICIPAL |
| FECHA: FEBRERO DE 2012 | SECRETARIA DE SALUD MUNICIPAL |
| PROYECTANTE: INGENIERIA Y ARQUITECTURA CIVIL GABRIEL GUEVARA SOLIS | SECRETARIA DE SALUD MUNICIPAL |
| CONSTRUCTOR: OMEGA INGENIERIA Y ARQUITECTURA CIVIL | SECRETARIA DE SALUD MUNICIPAL |
| PROYECTANTE: INGENIERIA Y ARQUITECTURA CIVIL GABRIEL GUEVARA SOLIS | SECRETARIA DE SALUD MUNICIPAL |

C:\Programas\dwg\581dwg\581vireviera\581vireviera.dwg - Escala: 1:125

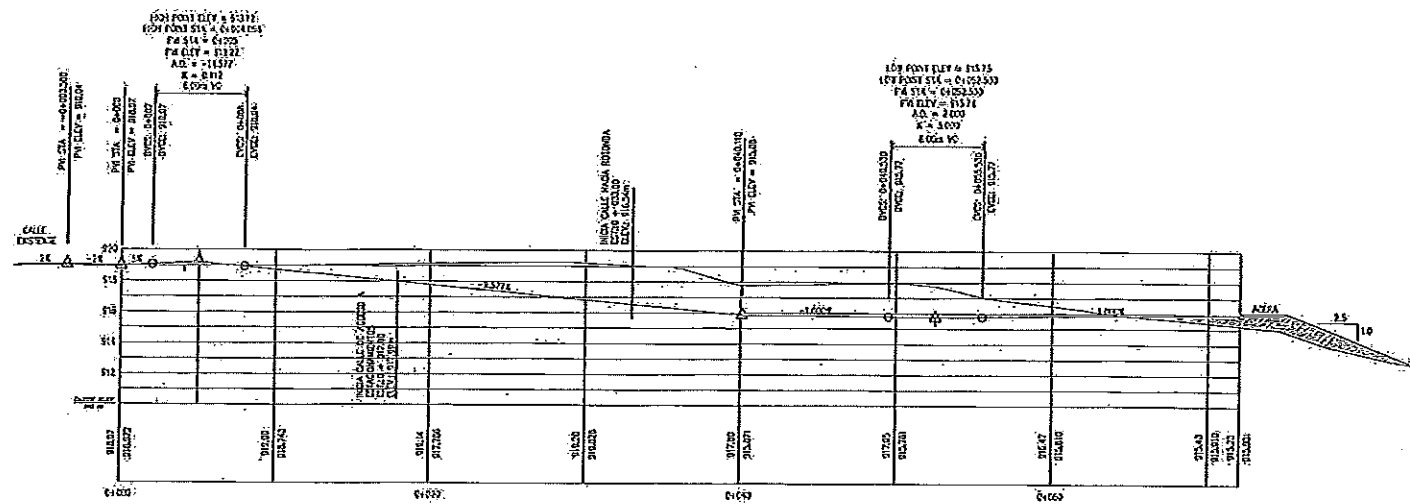

PERFIL CALLE PRIMERA
ESCA 1:100

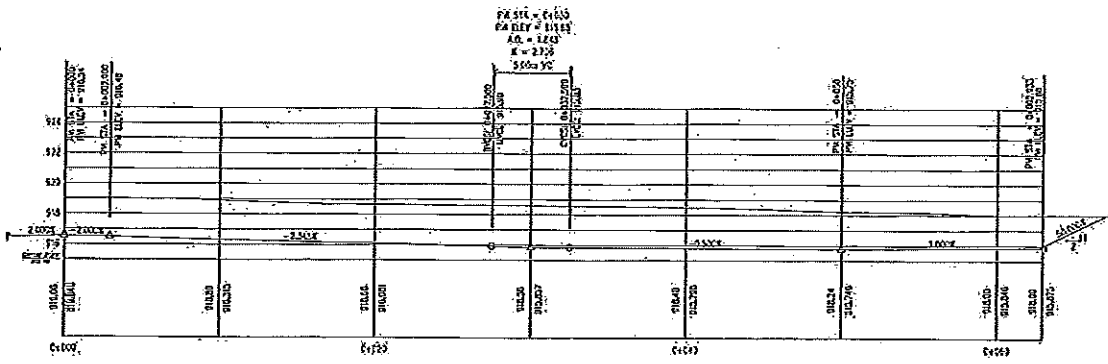

PERFIL CALLE SEGUNDA
ESCA 1:100

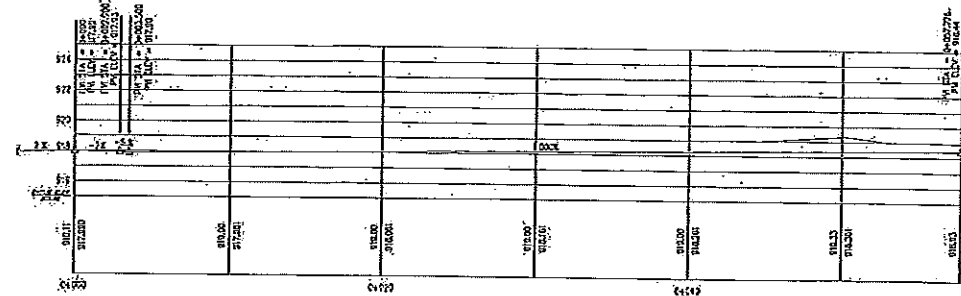

PERFIL ESTACIONAMIENTOS
ESCA 1:100

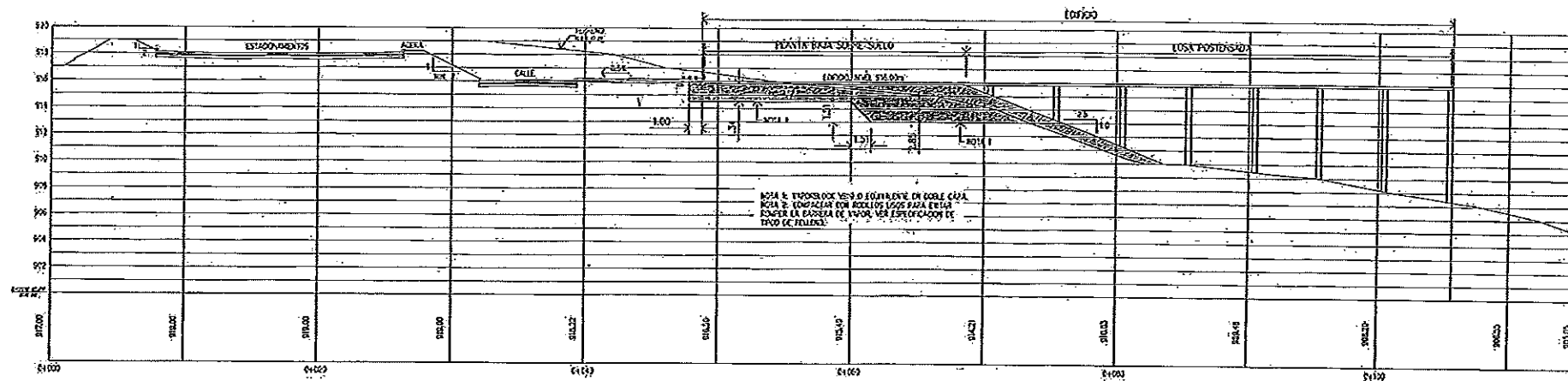

SECCION IX - PROYECTO
ESCA 1:100

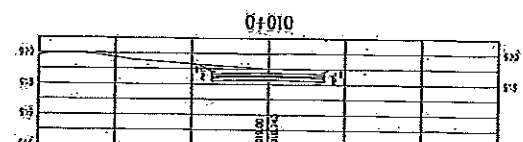
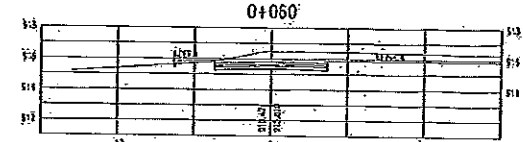
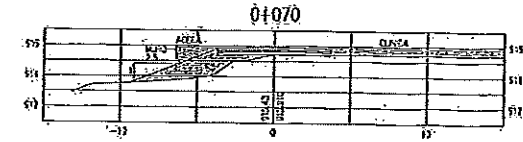
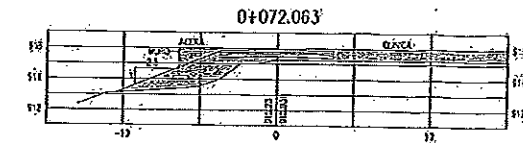

SECCIONES TRANSVERSALES CALLE PRIMERA
ESCA 1:20

AVILA C. FRANCO CAMPOS
ARQUITECTA
LICENCIADA N.º 014-001-001
Avila
Ley 15 del 24 de Enero de 1959
Justa Tercera de Ingeniería y Arquitectura

GABRIEL GUEVARA SOLIS
INGENIERO CIVIL
LICENCIADO N.º 000-000-001
Guevara
Ley 15 del 24 de Enero de 1959
Justa Tercera de Ingeniería y Arquitectura

CONTRACT SET

| | |
|--|--|
| N.º DE LA HOJA | |
| CIVIL - 3 | |
| FECHA | 02/02/2012 |
| ESTADO | PROYECTO PRELIMINAR PARA PERMISO |
| CLIENTE | INSTITUTO REGIONAL DE CONSTRUCCION S.A. |
| PROYECTO | PROYECTO DE OBRAS DE RECONSTRUCCION DE LA CALLE PRIMERA |
| TODAS LAS DIMENSIONES SON EN METROS | |
| DIRECCION DE INFRAESTRUCTURA DE SALUD INSPECCION DA-DIS-MINSA APROBADO PARA CONSTRUCCION Fecha: 02 de Febrero del 2012 Firma: <i>Guevara</i> | |
| MINISTERIO DE SALUD, REGIONAL DEL TAMBORA PRIMA OFICINA | DIRECCION DE OBRAS Y CONSTRUCCIONES REGIONAL |
| INSTITUTO REGIONAL DE CONSTRUCCION S.A. | DIRECCION DE OBRAS Y CONSTRUCCIONES REGIONAL |
| ANTERPROYECTO | IDENTIFICACION DEL PROYECTO DE SALUD (NOMBRE DEL PROYECTO) PROPIETARIO: MUNICIPIO UBICACION: PROVINCIA DE OMBUQUITO CORRECTOR DE DRENAJE DISTRITO DE BAMBACAY |
| CONTRUCTORA | CONTRUCTORA DE OBRAS Y CONSTRUCCIONES REGIONAL |
| CONSTRUYE | CONSTRUYE |
| OMEGA | OMEGA |
| ANEXO | ANEXO |
| PROYECTO | PROYECTO |
| DEPARTAMENTO DE PLANEACION | DEPARTAMENTO DE PLANEACION |
| REGIONAL | REGIONAL |